



Eagle 54

**Leonardo Yachts** was founded by two brothers, Steven & Melle Boersma. Located at the heart of the premium Dutch yachtbuilding industry in the Northern part of the Netherlands, we serve an international clientele with beautiful daysailers called the Eagle. Our portfolio consists of the Eagle 38, Eagle 44 and the Eagle 54. Many boats have been built and delivered to exiting locations worldwide. Our dream is to build beautiful daysailers that make heads turn.

As sailors it is a privilege for us to work in the yachting industry and we like nothing more than to create beautiful boats. It is also a pleasure to partner with owners to make their vision become reality.

If you share our passion for sailing, we would be honored to help fulfil your aspirations. Sailing is our life time passion and we hope to be part of your sailing dream.

Steven Boersma  
Sven Coster



# Eagle 54



Eagle 54

<b>Eagle 54</b>	
Length	16,64 meters (54'5")
Length waterline	10,90 meters (35'9")
Beam	3,27 meters (10'8")
Draft	2,80 meters (9'2") or 2,20 meters (7'3")
Mast height	20,30 meters (66'7") above DWL
Construction	Foam core epoxy with carbon fibre reinforced frames
Displacement	9.000 Kg (19840 lbs) of which 3.705 Kg ballast (8170 lbs)
Sail area	129,3 m2 (1392 ft2)
Engine	Volvo D2-40 hp saildrive
CE category	B (sea)
Design	Hoek Design ( <a href="http://www.hoekdesign.com">www.hoekdesign.com</a> )
Cockpit	Self bailing with teak wood flooring
Deck / hatches	Teak wood deck /deck hatch
Interior	White panels with teak wood finish
Berths	4 to 6 depending on interior layout
Diesel tank	150 lt fuel in stainless steel tank (39.5 Gal)
Water tanks	185 lt fresh water (47.4 Gal), 100 lt waste tank (26.3 Gal)

The Eagle 54 offers a spacious cockpit, has elegant, classic lines combined with modern features and a modern underwater ship. The laminated vacuum epoxy injected hull with foam core, which is reinforced with carbon, makes a light but stiff structure that adds to the excellent sailing behaviors. The boat is designed with shorthanded cruising in mind. As the 54 will be a semi custom boat you can decide upon the interior styling. Standard the interior is bright white with beautiful crafted teak joinery details, a traditional mahogany or teak interior is possible as well as a modern design.

**Ultra sleek deck**

With halyards and the jib sheets running below the all teak deck the Eagle 54 has an ultra sleek deck layout. For ease of handling the jib winches are positioned within reach of the helmsman. Just forward of the jib winches the two halyard winches that double as gennaker sheet winches. The halyards tails are neatly tucked away in a practical self draining box in the cockpit coaming. A captive winch mounted below decks allows the mainsheet to be trimmed with the push of a button as is the powered headsail furler which is also mounted below deck. The standard rigging is in carbon with an inboom furling mainsail. An extensive hydraulic package will allow you to adjust vang and backstay tension all from the helm.

**Less hassle more fun**

All these systems will ensure the Eagle 54 can be sailed single-handed. Sailing an Eagle should be uncomplicated fun. And with only ~9 tons displacement the Eagle 54 will turn heads not only by looking beautiful but also because of her sailing characteristics.



Eagle 54

### Below deck

Describing the boat from front to back, most forward there is the anchor locker with a deck hatch. Manually one has to lift the anchor with custom stainless steel anchor arm over the side. (half of the weight is carried by the hinge). Now the anchor can be dropped or taken up using the powered Lewmar windlass. When the anchor is stowed there is room for 3 fenders.

Directly behind the anchor hatch the hatch for the forepeak is located. This is a dry storage space. Located below the floor is the retractable bowthruster. Two bars are fitted on which one can secure gennaker sheets and mooring lines. Behind the watertight bulkhead the master cabin is situated. The room has 2 little seats that are convenient when changing clothes and the cabin has a clothing locker on each side. A sliding door encloses the master bedroom.

Behind the door the galley situated on the port side with a fridge, electrical cooking hob, sink and teak working top. The bathroom, which is opposite to the galley, features several lockers and cupboards, an electric operated toilet and a shower.

The saloon has a nice teak table with storage space (bar) inside and a settee on each side. There is ample of space to seat 6 people comfortably. There are 3 lockers, and 4 shelves in the saloon. From the saloon also the so-called pilot berths are accessed, each have a bed side reading light.

The engine can be accessed via the cabin entrance steps and service hatches located near the pilot berths.

**The large cockpit** offers ample seating for several people, has 2 cockpit lockers and a nice varnished mahogany table to serve your comfort. Inside the table there is a second fridge for keeping your drinks cool and at hand. Below the helm seat the steering quadrant, boiler, optional air-conditioning and battery charger are fitted. This space is separated from the aft lazarette by a bulkhead and removable access hatch. The lazarette is accessed from the 2 aft deck hatches. This space is a dry storage space.

### Construction

- Foam-core epoxy hull laminate, standard finished in a white gel coat (RAL 9001)
- Carbon reinforced frames in high load areas (keel and chainplates)
- Foam-core epoxy laminate superstructure finished in a white gel coat (RAL 9001)
- A recessed cove line
- Below the waterline epoxy primers and barrier coat finished with white or black antifouling
- Inside of hull / bilges painted white
- 8 mm teak deck
- Cabin roof in teak finish with a varnished mahogany margin plank
- High performance modern T-bulb fin keel.  
Stainless steel construction, GRP fin fairing, lead bulb
- Polycarbonate sliding cabin entrance hatch with skylight extending forward
- Forward skylight emergency escape hatch
- Flush teak anchor locker hatch with gas spring
- Flush teak forward deck hatch storage with gas spring fitting to store lines and fenders
- Large aft lazarette with double opening hatches with gas springs

### Technical equipment and motorisation

- Volvo D2-50 hp 36.7 kW saildrive (115 A alternator).
- 3-blade folding propeller
- Motor control panel in cockpit, Volvo stainless steel throttle
- Lewmar 185 mm 4 kw retractable swing bow thruster
- Batteries: 3 x 200 Ah AGM service, 1x 50 Ah start battery, 1 x 50 Ah bowthruster/anchor windlass battery



# Eagle 54

- Mastervolt shore power cable
- Mastervolt Combi shore power charger and inverter 12V/4000W/100Ah
- Custom stainless steel control panel
  - Level indicators for fresh water, waste tank and fuel level
  - Mastervolt battery management touch screen
  - Stainless steel push button control buttons for all functions
- Fresh water system
- Boiler 40 L operating on engine and shore power
- Waste water system with option to discharge into sea or at shore station
- 3 x automatic bilge pumps (Johnson)
- 1 x Manual bilge pump
- LED Navigational lights; 3-colour top, anchor, steam, stern and red/green bow lights

### **Deck equipment and rigging**

- Lewmar electric anchor winch V3(fitted below deck)
- 20 kg Delta anchor, with custom stainless steel folding arm to stow the anchor below deck
- 25 m 10 mm chain (57.5 kg)
- Low toe rail in bare teak wood with chromed fittings (like a low railing)
- 6 classic teak / stainless steel mooring cleats
- 2 Antal Stainless steel genua tracks with cars
- Below deck mounted electric Genua-furler Furlex TD 300E mm with tensioner
- 2 x Folding pad eyes for gennaker blocks
- 2 x Folding padeyes for barberhaulers
- 1 x Padeye to secure halyards

- 1 x D-eye for gennaker tack point
- Emergency mainsheet point
- Electric captive mainsheet winch (mounted below deck), Lewmar CW800
- Emergency mainsheet system
- Electric winches (all chromed bronze with stainless steel top)
- 2x Lewmar 65 STE EVO CH selftailing electric jib winches,
- 2x Lewmar 55 STE EVO CH selftailing electric halyard winches
- 6 x spinlock XX0812-S stoppers for the halyards, tack line and boom furling line
- Axxon Spars Carbon mast, 2 sets of spreaders, all painted white
- BSI rod rod rigging
- Headstay: Nitronic rod -15, backstay: 5T Kevlar tail to suit below deck installed A250-012 hydraulic backstay tensioner
- V1: Nitronic rod -22 including L500 spreader tip cups and C890 turnbuckles
- V2/D3 (continuous capshrouds): Nitronic rod -15 including micro stemballs,
- D1: Nitronic rod -15 and C890 turnbuckles.
- D2: Nitronic rod 6 including C651 tip turnbuckles.
- Spreader up lights and deck lights
- Manual operated hydraulic panel
  - Backstay control • Vang control
- Furler Boom (mainsail furling in boom)
- Endless furling line and integrated sail cover
- 2 LED lights in the boom installed over the cockpit
- Windex
- North Sails soft Norlam 9.0 NLXW, mainsail 72,6 m2,
- furling jib 100% 56,7 m2 plus sailbags
- Jib cover



# Eagle 54

All necessary halyards, sheets and lines:

- 1 Mainhalyard (1:1): 10 mm DSK 78 Club PC and headboard shackle
- 1 Masthead spinnakerhalyard 10 mm DSK 78 Club PC with Tylaska T-12 snapshackle, tapered with ball
- 1 Jib halyard 10 mm DSK 78 Club PC including Wichard HR D-shackle for attachment to swivel of yard supplied Selden furling system
- 1 Reefline line 10 mm Dyneema (to suit Furlerboom)
- 2 Burgeelines
- 1 Mainsheet 10 mm DSK 78 Club PC to suit mainsheet system
- 2 Jibsheet 10 mm DSK 78 Club PC, including loop shackles
- 2 Gennakersheets 10 mm DSK 78 Club Poly and Tylaska T-12 snapshackles
- 1 Tackline 10 mm DSK 78 Club PC including Tylaska T-12 snapshackle

**Cockpit**

- Self draining
- Teak flooring
- Benches / cockpit lockers finished in teak
- Exclusive Sunbrella upholstery, colour by choice
- High gloss varnished mahogany cap rail on the cockpit coaming
- Luxurious mahogany cockpit table with refrigerator box and storage possibilities
- Edson steering pedestal finished with mahogany compass rim
- Stainless steel 7 spoke steering wheel with mahogany rim
- Stainless steel Ritchie compass with light
- 2 cockpit lockers
- Cockpit shower

- LED cockpit lights (4)
- Exterior radio control
- 2 marine speakers

**Interior**

- Teak holly wood matt varnished flooring
- White painted ceiling panels
- Mat varnished teak interior combined with white panels

**Salon**

- Two 2 m long sofa's with storage space inside, owner's choice of Sunbrella upholstery
- Central table with bar box
- 4 cabinets
- Stainless steel fittings
- 4 x ceiling lights LED dimmable
- 2 x AC sockets
- POLK Radio with Bluetooth connection 2 x Polk speakers interior 2 x Jensen speakers exterior

**Master bedroom**

- Large double V-berth (length 210 cm)
- 2 clothing lockers, with shelves and hanging space
- Blinds for overhead escape hatch (Ocean air)
- 3 x ceiling lights LED dimmable
- 2 x bedside LED reading lights
- 2 x AC sockets



Eagle 54

**Bathroom**

- Marine electric toilet Vetus Marine TMWQ 12V with soft close
- Matt varnished teak basin top
- Wash basin with mixing tap
- Shower with mixing tap
- Ceiling light (LED)
- Lockers
- Overhead ventilation
- 1 AC socket

**Galley**

- Refrigerator with freezer compartment Make VITRIFRIGO Type DW51RFX 12V
- Marine electric stove Kenyon Mediterranean series 2 zone 230V/110V
- Varnished teak working top
- Integrated stainless steel sink with mixing tap
- Wall and lower cabinets
- 1 x double AC socket

**Miscellaneous**

- 6 Inflatable fenders with fender covers
- 4 Mooring lines (black or white braided)
- 2 Fire extinguishers
- 1 Automatic fire extinguisher for the engine compartment (MABO)
- Flag staff with flag of choice
- Boat name on the stern (sticker)

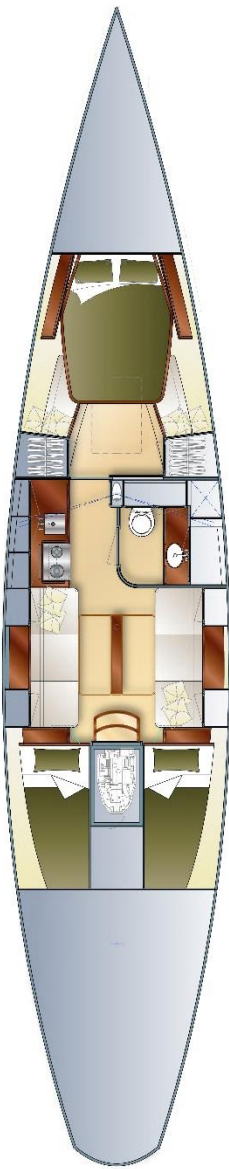

Eagle 54

## Price Eagle 54, VAT excluded € 825.000,-

The Eagle 54 can be equipped with various options to meet your personal preferences.

Contact us for more information on [info@leonardoyachts.com](mailto:info@leonardoyachts.com)

Delivery ex-works Sneek-The Netherlands, terms and conditions apply.  
Prices and modifications reserved, january 2019



# Eagle 54



Eagle 54



Eagle 54



Eagle 54



Eagle 54





Eagle 54



Eagle 54



**Leonardo Yachts BV**  
Zwolsmanweg 5  
8606 KC Sneek The Netherlands

**W** [www.leonardoyachts.com](http://www.leonardoyachts.com)  
**E** [info@leonardoyachts.com](mailto:info@leonardoyachts.com)  
**T** +31 515 209 002

# Eagle 54